

## RACCORDI STANDARD - ACCESSORI - SILENZIATORI

STANDARD FITTINGS - ACCESSORIES - SILENCERS  
RACCORDS STANDARDS - ACCESSOIRES - SILENCIEUX

RACCORDS STANDARDS - ACCESSOIRES - SILENCIEUX  
STANDARDVERSCHRAUBUNGEN



### CARATTERISTICHE TECNICHE

**CAMPI DI IMPIEGO:** Circuiti pneumatici, oleodinamici e idraulici.

**RACCORDI STANDARD:** L - T - Y -CROCE - L PORTAGOMMA.

**ACCESSORI:** NIPPOLO - RIDUZIONI - MANICOTTI - TAPPI - PORTAGOMMA - PASSAPARETE.

**Pressione d'esercizio:** La pressione nominale (BAR) dei raccordi è sempre superiore alla pressione di utilizzo del tubo. La pressione massima d'esercizio è determinata dalle caratteristiche del tubo impiegato.

Pressione massima consigliata 60 Bar.

**Temperatura:** La temperatura è determinata dalle caratteristiche del tubo impiegato.

Temperatura OR NBR 70: min.-20°C ; max. + 100°C

Temperatura OR VITON (FKM): min.-15°C ; max. +200°C

**Materiali impiegati:** Ottone UNI EN 12164 CW 614N. Ottone UNI EN 12165 CW 617N.

**Trattamento superficiale:** Nichelatura.

#### **RIPARTITORI ALLUMINIO:**

**Pressione d'esercizio:** 12 Bar.

**Materiali impiegati:** ALLUMINIO LEGA 2011 T3-UNI EN 573-3.

**Trattamento superficiale:** Ossidazione anodica (art.3760). Burattatura (art.3671-3672).

#### **SILENZIATORI:**

Silenziatori in FILO ACCIAIO E BRONZO SINTERIZZATO:

**Pressione d'esercizio:** 12 Bar.

**Temperatura:** -10°C / +80°C

Silenziatori NYLON STATICO/DINAMICO:

**Pressione d'esercizio:** 6 Bar.

**Temperatura:** 10°C / +70°C

**Materiali impiegati:** CORPO (art.3730) - Ottone UNI EN 12164 CW 614N. RETINA (art.3730) - FILO ACCIAIO INOX AISI 304. CORPO (art.3731) - FILTRO (art.3731) - NYLON. BRONZO SFERICO SINTERIZZATO (art.3732-3733).

**Trattamento superficiale corpo ottone:** Nichelatura.

**FILETTATURE:** Gas conica ISO 7 (BSPT)- DIN 2999 - BS 21. Gas cilindrica - ISO 228 (BSPP). Metrica - ISO R/262.

I prodotti sono conformi alla direttiva 2002/95/EC -RoHS-

### TECHNICAL FEATURES

**FIELDS OF APPLICATION:** Pneumatic, hydraulic and oil-hydraulic systems.

**STANDARD FITTINGS:** ELBOWS, TEES, Y, CROSS, HOSE CONNECTOR ELBOW.

**ACCESSORIES:** NIPPLES, REDUCERS, SLEEVES, PLUGS, HOSE CONNECTOR, BULKHEAD CONNECTOR

**Working pressure:** The pressure (BAR) of the fittings is always higher than the pressure used in the pipe. Pressure depend on the pipe's features used.

Max pressure suggested 60 Bar.

**Temperature:** The temperature depend on the pipe's features used.

Temperature O-Ring NBR 70 : min.-20° C ; max.+100°C

Temperature O-Ring VITON (FKM): min.-15°C ; max.+200°C

**Materials used:** Brass UNI EN 12164 CW 614N. Brass UNI EN 12165 CW 617N.

**Surface treatment:** Nickel-plating.

**ALUMINIUM DISTRIBUTORS:**

**Working pressure:** 12 Bar

**Materials used:** ALUMINIUM ALLOY 2011 T3- UNI EN 573-3.

**Surface treatment:** Anodic oxidation (item 3670). Vibrating (item 3671-3672).

**SILENCERS:**

Silencers STEEL WIRE AND SINTERED BRONZE

**Working pressure:** max.12 bar.

**Temperature:** -10°C / +80°C

Silencers NYLON STATIC/DINAMIC

**Working pressure:** 6 BAR.

**Temperature:** -10°C/ +70°C

**Materials used:** BODY (item 3730) - Brass UNI EN 12164 CW 614N. WIRE NET (item 3730) - STEINLESS STEEL WIRE AISI 304. BODY (item 3731) - FILTER (item 3731) - NYLON. SINTERED GLOBULAR BRONZE (items 3732-3733).

**Surface treatment for brass's body:** Nickel-plating.

**THREADS:** Conical gas - ISO7 (BSPT)- DIN 2999 - BS21. Cylindrical gas - ISO 228 (BSPP). Metric - ISO R/262.

Products in conformity with the directive 2002/95/EC –RoHS-

## CARACTÉRISTIQUES TECHNIQUES

**DOMAINES D'APPLICATION:** Systèmes pneumatiques et oléohydrauliques.

**RACCORDS STANDARDS:** ÉQUERRE, TÉ, Y, CROIX, L PORTE-CAOUTCHOUC.

**ACCESSOIRES:** MAMELON, RÉDUCTION, MANCHONS, BOUCHONS, DOVILLES CONNELEES, TRAVERSEES DE CLOISON.

**Pression:** La pression nominale (BAR) des raccords est toujours plus haute que la pression du tuyau utilisé.

Pression est en fonction du type du tuyau employé, ces valeurs seront donc définies sur la base des caractéristiques techniques du tuyau.

Pression max. conseillée 60 Bar.

**Température:** température est en fonction du type du tuyau employé, ces valeurs seront donc définies sur la base des caractéristiques.

Température O-Ring NBR 70 : min.-20°C ; max.+100°C

Température O-Ring VITON (FKM): min.-15°C ; max.+200°C

**Materiels utilises:** Laiton UNI EN 12164 CW 614N. Laiton UNI EN 12165 CW 617N.

**Traitement de la superficie:** Nickelage.

**ALUMINIUM DISTRIBUTORS:**

**Pression:** 12 Bar

**Materiels utilises:** ALUMINIUM ALLIAGE 2011 T3- UNI EN 573-3.

**Traitement de la superficie:** Oxydation anodique (art.3670). Blutage (art.3671-3672).

**SILENCIEUX:**

Silencieux EN FIL D'ACIER ET EN BRONZE :

**Pression:** 12 Bar

**Température:** -10°C / +80 :C

Silencieux NYLON STATIQUE/DYNAMIQUE :

**Pression:** 6 Bar.

**Température:** -10°C /+ 70°C

**Materiels utilises:** CORPS (art.3730) - Laiton UNI EN 12164 CW 614N. GRILLE (art. 3730) - FIL D'ACIER INOXYDABLE AISI 304. CORPS (art 3731) - FILTRE (art.3731) - NYLON. BRONZE SPHERIQUE FRITTE (art.3732 - 3733).

Traitement de la superficie pour corp en laiton: Nickelage.

**FILETAGÉ:** Gaz conique - ISO7(BSPT) - DIN 2999 - BS21. Gaz cylindrique - ISO 228 (BSPP). Metrique - ISO R/262.

Produits en conformité avec la directive –RoHS- 2002/95/EC

## TECHNISCHE MERKMALE

**ANWENDUNGSGEBIET:** Pneumatische, ölhydraulische und hydraulische Kreisläufe.

**STANDARD ANSCHLUBSTÜCKE:** WINKEL, T-, Y- und kreuz-stück, L Schlauchverbinder.

**ZUBEHÖRTEILE:** Nippel, Reduktionsnippel, Doppelnippel, Muffen, Stopfen, Schlauchtülle, Schlauchverbinder, Schottverschraubung.

## RACCORDI STANDARD - ACCESSORI - SILENZIATORI

STANDARD FITTINGS - ACCESSORIES - SILENCERS

**Druckbereich:** Der Nenndruck (BAR) der Anschlußteile ist immer höher als der Betriebsdruck in den Röhren. Druckbereich wird von Eigenschaften der verwendeten Röhren bestimmt.

Max. Druck empfohlen 60 Bar.

**Temperatur:** Temperatur wird von Eigenschaften der verwendeten Röhren bestimmt.

Temperatur O-Ring NBR 70: min.-20°C ; max +100°C

Temperatur O-Ring VITON (FKM): min.-15°C ; max.+200°C

**Verwendete Materialien:** Messing UNI EN 12164 CW 614N. Messing UNI EN 12165 CW 617N.

**Oberflächenbehandlung:** Vernickelt.

### **ALUMINIUM-VERTEILER:**

**Druckbereich:** 12 Bar

**VERWENDETE MATERIALEN:** ALU-LEGIERUNG 2011 T3-UNI EN 573-3.

**OBERFLÄCHENBEHANDLUNG:** Anodische Oxydation (Art.-3670). Trowaliert (Art.-3671-3672).

### **SCHALLDÄMPFER:**

Schalldämpfer EDELSTAHL DRAHT UND SINTERBRONZE

**Druckbereich:** 12 Bar.

**Temperatur:** -10°C / +80°C

Schalldämpfer STATISCHE/ DYNAMISCHE NYLON:

**Druckbereich:** 6 Bar

**Temperatur:** -10°C / +70°C

VERWENDETE WERKSTOFFEN KÖRPER (Art.-3730) - Messing UNI EN 12164 CW 614N. NETZ (Art.-3730) -

EDELSTAHL DRAHT AISI 304. KÖRPER (Art.-3731) - FILTER (Art.-3731) - NYLON. RUNDKÖRNIGE SINTERBRONZE (Art.-3732 - 3733).

**Messingkörper Oberflächenbehandlung:** Vernickelt.

**GEWINDE:** Konisches Gasgewinde ISO7 (BSPT)- DIN2999 - BS21. Zylindrisches Gasgewinde ISO 228 (BSPP). Metrisch ISO R/262.

Die Produkte entsprechen der Richtlinie 2002/95/EC –RoHS-

## CARACTERISTICAS TECNICAS

**CAMPOS DE EMPLEO:** Circuitos neumáticos, oleodinámicos y hidráulicos.

**RACORES ESTÁNDARES:** CODO – TE – Y – CRUZ – CODO PORTATUBO.

**ACCESORIOS:** MACHÓN - REDUCCIONES - MANGUITOS - TAPÓN - ESPIGA - PASATABIQUES.

**Presión:** La presión nominal (BAR) de los racores es siempre mayor que la presión de trabajo en el tubo. La presión esta determinada por el tipo de tubo empleado, por lo tanto estos valores tienen que ser definidos por las características técnicas del tubo mismo.

Presión máxima aconsejada 60 Bar.

**Temperatura:** La temperatura esta determinada por el tipo de tubo empleado.

Temperatura O-Ring NBR: min.-20°C ; max .+ 100°C

Temperatura O-Ring VITON (FKM): min.-15°C ; max .+200°C

**Materiales empleados:** Latón UNI EN 12164 CW 614N. Latón UNI EN 12165 CW 617N.

**Tratamiento superficial:** Niquelado.

### **REPARTIDORES DE ALUMINIO:**

**Presión máxima de trabajo:** 12 Bar

**Materiales empleados:** ALEACIÓN DE ALUMINIO 2011 T3- UNI EN 573-3.

**Tratamiento superficial:** Oxidación anódica (art.3670). Vibrado (art.3671-3672).

### **SILENCIADORES:**

Silenciadores de REDECILLA DE ACERO Y BRONCE SINTERIZADO:

Presión máxima de trabajo: 12 bar.

**Temperatura:** -10°C / +80°C

Silenciadores NYLON ESTÁTICO/DINÁMICO:

**Presión máxima de trabajo:** 6 BAR.

**Temperatura:** -10°C / +70°C

**Materiales empleados:** CUERPO (art. 3730) - Latón UNI EN 12164 CW 614N. REDECILLA (art. 3730) - ALAMBRE DE ACERO INOXIDABLE AISI 304. CUERPO (art. 3731) - FILTRO (art. 3731) - NYLON. BRONCE ESFERICO SINTERIZADO (art. 3732- 3733).

**Tratamiento superficial cuerpo laton:** Niquelado.

**ROSCAS:** Gas cónicas ISO7(BSPT) - DIN2999 - BS21. Gas cilíndricas ISO228 (BSPP). Métricas ISO R/262.

Productos de conformidad a la Directiva –RoHS- 2002/95/EC

# RACCORDI STANDARD - ACCESSORI - SILENZIATORI

STANDARD FITTINGS - ACCESSORIES - SILENCERS

**L M.M. COMPATTO**  
ELBOW M.M. COMPACT

**3400**

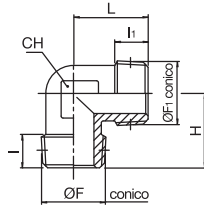

ARTICOLO	F	F1	I	I1	H	L	CH
34000800	1/8	1/8	8	8	17	17	10
34001700	1/4	1/4	11,5	11,5	22,5	22,5	12
34002600	3/8	3/8	12,5	12,5	25,5	25,5	15
34003500	1/2	1/2	14	14	30	30	19
34004900	3/4	3/4	17	17	34,5	34,5	22
34005300	1"	1"	18,5	18,5	40,5	40,5	28

**L M.F. COMPATTO**  
ELBOW M.F. COMPACT

**3410**

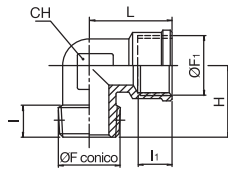

ARTICOLO	F	F1	I	I1	H	L	CH
34100800	1/8	1/8	8	8	17	18,5	10
34101700	1/4	1/4	11,5	11,5	22,5	22,5	12
34102600	3/8	3/8	12,5	11,5	25,5	25,5	15
34103500	1/2	1/2	14	14	30	30	19
34104900	3/4	3/4	17	16,5	34,5	35,5	22
34105300	1"	1"	19	18	40,5	40,5	28

**L F.F. COMPATTO**  
ELBOW F.F. COMPACT

**3420**

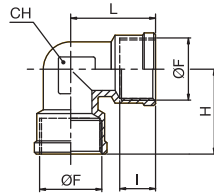

ARTICOLO	F	I	H	L	CH
34200800	1/8	8	18,5	18,5	10
34201700	1/4	11,5	22,5	22,5	12
34202600	3/8	11,5	25,5	25,5	15
34203500	1/2	14	30	30	19
34204900	3/4	16,5	35,5	35,5	22
34205300	1"	18	40,5	40,5	28

**T M.M.M. COMPATTO**  
TEE M.M.M. COMPACT

**3430**

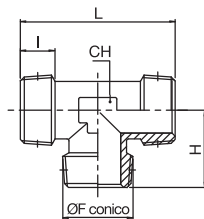

ARTICOLO	F	I	H	L	CH
34300800	1/8	8	17	34	10
34301700	1/4	11,5	22,5	45	12
34302600	3/8	12,5	25,5	51	15
34303500	1/2	14,5	30	60	19
34304900	3/4	17	34,5	69	22
34305300	1"	19	40,5	81	28

**T M.F.M. COMPATTO**  
TEE M.F.M. COMPACT

**3440**

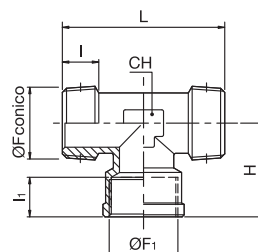

ARTICOLO	F	F1	I	I1	H	L	CH
34400800	1/8	1/8	8	8	18,5	34	10
34401700	1/4	1/4	11	11	22,5	45	12
34402600	3/8	3/8	12,5	11,5	25,5	51	15
34403500	1/2	1/2	14,5	14	30	60	19
34404900	3/4	3/4	17	16,5	35,5	69	22
34405300	1"	1"	19	18	40,5	81	28

**RACCORDI STANDARD - ACCESSORI - SILENZIATORI**

STANDARD FITTINGS - ACCESSORIES - SILENCERS

**T M.F.F. COMPATTO**  
TEE M.F.F. COMPACT

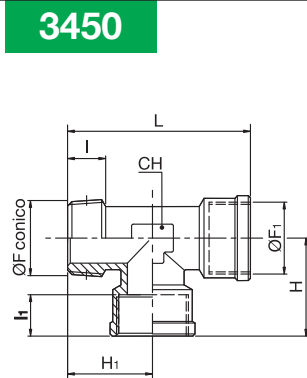

**3450**

ARTICOLO	F	F1	I	I1	H	H1	L	CH
34500800	1/8	1/8	8	8	18,5	17	35,5	10
34501700	1/4	1/4	11,5	11	22,5	22,5	45	12
34502600	3/8	3/8	12,5	11,5	25,5	25,5	51	15
34503500	1/2	1/2	14,5	14	30	30	60	19
34504900	3/4	3/4	17,5	16,5	35,5	34,5	70	22
34505300	1"	1"	19	18	40,5	40,5	81	28

**T F.F.F. COMPATTO**  
TEE F.F.F. COMPACT

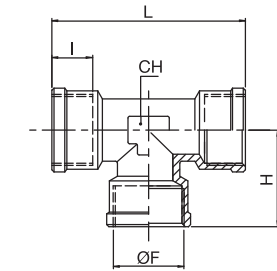

**3460**

ARTICOLO	F	I	H	L	CH
34600800	1/8	8	18,5	37	10
34601700	1/4	11	22,5	45	12
34602600	3/8	11,5	25,5	51	15
34603500	1/2	14	30	60	19
34604900	3/4	16,5	35,5	71	22
34605300	1"	18	40,5	81	28

**T F.M.F. COMPATTO**  
TEE F.M.F. COMPACT

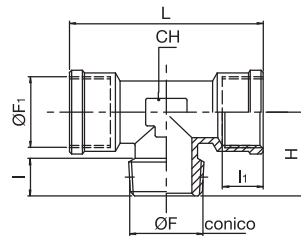

**3470**

ARTICOLO	F	F1	I	I1	H	L	CH
34700800	1/8	1/8	8	8	17	37	10
34701700	1/4	1/4	11,5	11	22,5	45	12
34702600	3/8	3/8	12,5	11,5	25,5	51	15
34703500	1/2	1/2	14,5	14	30	60	19
34704900	3/4	3/4	17	16,5	34,5	71	22
34705300	1"	1"	19	18	40,5	81	28

**T M.M.F. COMPATTO**  
TEE M.M.F. COMPACT

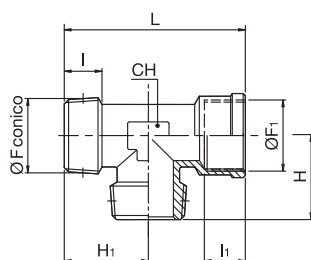

**3480**

ARTICOLO	F	F1	I	I1	H	H1	L	CH
34800800	1/8	1/8	8	8	17	17	35,5	10
34801700	1/4	1/4	11,5	11	22,5	22,5	45	12
34802600	3/8	3/8	12,5	11,5	25,5	25,5	51	15
34803500	1/2	1/2	14,5	14	30	30	60	19
34804900	3/4	3/4	17,5	16,5	34,5	34,5	70	22
34805300	1"	1"	19	18	40,5	40,5	81	28



# RACCORDI STANDARD - ACCESSORI - SILENZIATORI

STANDARD FITTINGS - ACCESSORIES - SILENCERS

**L M.M.**  
ELBOW M.M.

**3510**

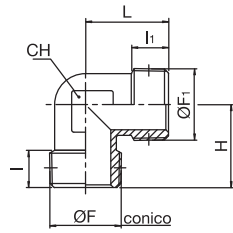

ARTICOLO	F	F1	I	I1	H	L	CH
35100300	M5	M5	4	4	11,5	11,5	9
35100800	1/8	1/8	8	8	18,5	18,5	10
35101700	1/4	1/4	11	11	23,5	23,5	13
35101800	1/4	1/8	11	8	21,5	18,5	10
35102600	3/8	3/8	11,5	11,5	26	26	17
35103500	1/2	1/2	14	14	31	31	21
35104900	3/4	3/4	16	16	33	33	25
35105300	1"	1"	17	17	39	39	30

**L M.M. GIALLO**  
ELBOW M.M. NOT NICKEL PLATED

**D3510**

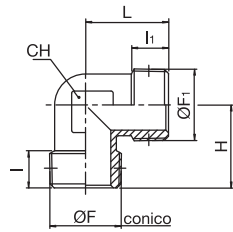

ARTICOLO	F	F1	I	I1	H	L	CH
D35100300	M5	M5	4	4	11,5	11,5	9
D35100800	1/8	1/8	8	8	18,5	18,5	10
D35101700	1/4	1/4	11	11	23,5	23,5	13
D35101800	1/4	1/8	11	8	21,5	18,5	10
D35102600	3/8	3/8	11,5	11,5	26	26	17
D35103500	1/2	1/2	14	14	31	31	21
D35104900	3/4	3/4	16	16	33	33	25
D35105300	1"	1"	17	17	39	39	30

**L M.F.**  
ELBOW M.F.

**3520**

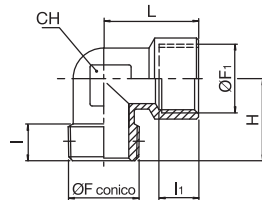

ARTICOLO	F	F1	I	I1	H	L	CH
35200300	M5	M5	4	5	11,5	11	9
35200800	1/8	1/8	8	8	18,5	21	10
35201700	1/4	1/4	11	11	23,5	25,5	13
35201800	1/4	1/8	11	8	21,5	21	10
35202600	3/8	3/8	11,5	11,5	26	28	17
35203500	1/2	1/2	14	14	31	33,5	21
35204900	3/4	3/4	16	16,5	33	36,5	25
35205300	1"	1"	17	19	39	45	30

**L M.F. GIALLO**  
ELBOW M.F. NOT NICKEL PLATED

**D3520**

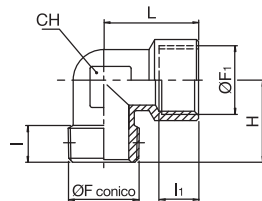

ARTICOLO	F	F1	I	I1	H	L	CH
D35200300	M5	M5	4	5	11,5	11	9
D35200800	1/8	1/8	8	8	18,5	21	10
D35201700	1/4	1/4	11	11	23,5	25,5	13
D35201800	1/4	1/8	11	8	21,5	21	10
D35202600	3/8	3/8	11,5	11,5	26	28	17
D35203500	1/2	1/2	14	14	31	33,5	21
D35204900	3/4	3/4	16	16,5	33	36,5	25
D35205300	1"	1"	17	19	39	45	30

**L F.F.**  
ELBOW F.F.

**3530**

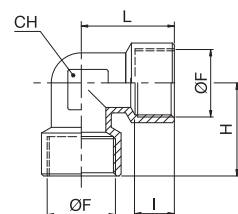

ARTICOLO	F	I	H	L	CH
35300300	M5	5	11	11	9
35300800	1/8	8	21	21	10
35301700	1/4	11	25,5	25,5	13
35302600	3/8	11,5	28	28	17
35303500	1/2	14	33,5	33,5	21
35304900	3/4	16,5	36,5	36,5	25
35305300	1"	19	45	45	30

# RACCORDI STANDARD - ACCESSORI - SILENZIATORI

STANDARD FITTINGS - ACCESSORIES - SILENCERS

**L F.F. GIALLO**  
ELBOW F.F. NOT NICKEL PLATED



**D3530**

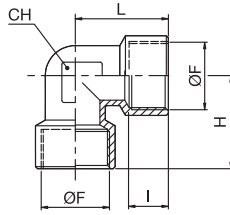

ARTICOLO	F	I	H	L	CH
D35300300	M5	5	11	11	9
D35300800	1/8	8	21	21	10
D35301700	1/4	11	25,5	25,5	13
D35302600	3/8	11,5	28	28	17
D35303500	1/2	14	33,5	33,5	21
D35304900	3/4	16,5	36,5	36,5	25
D35305300	1"	19	45	45	30

**L PORTAGOMMA MASCHIO 90°**  
ELBOW HOSE CONNECTOR 90° MALE



**3535**

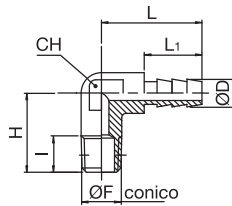

ARTICOLO	D	F	I	H	L	L1	CH
35351570	6	1/8	8	18,5	22,5	14	8
35351571	6	1/8	10	23	22,5	14	8
35351580	6	1/4	11	23	23	14	9
35351610	7	1/8	8	18,5	22,5	14	8
35351611	7	1/8	10	23	22,5	14	8
35351620	7	1/4	11	23	23	14	9

**L PORTAGOMMA FEMMINA 90°**  
ELBOW HOSE CONNECTOR 90° FEMALE



**3536**

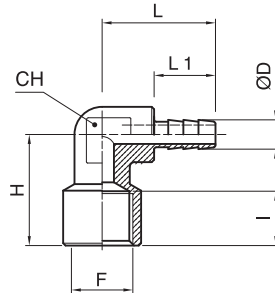

ARTICOLO	D	F	I	H	L	L1	CH
35361570	6	1/8	8	22	22	13	9
35361580	6	1/4	11	23,5	24	13	13
35361610	7	1/8	8	22	24	13	9
35361620	7	1/4	11	23,5	24	13	13

**L PORTAGOMMA MASCHIO 90° SERIE LUNGA**  
ELBOW HOSE CONNECTOR 90° MALE LONG SERIES



**3538**

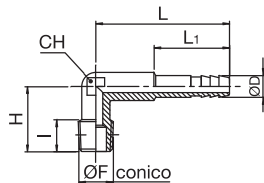

ARTICOLO	D	F	I	H	L	L1	CH
35381570	6	1/8	10	22	32,5	14	9
35381571	6	1/8	8	18,5	38	22	8
35381580	6	1/4	11	23	32,5	14	9
35381610	7	1/8	10	22	32,5	14	9
35381611	7	1/8	8	18,5	38	22	8
35381620	7	1/4	11	23	32,5	14	9

**L PORTAGOMMA MASCHIO 90° RAGGIATO**  
ELBOW HOSE CONNECTOR 90° MALE RADIUS



**3539**

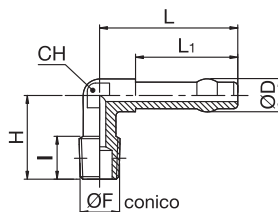

ARTICOLO	D	F	I	H	L	L1	CH
35391570	6	1/8	11	20,5	34,5	25	9
35391580	6	1/4	11,5	21	34,5	25	9
35391610	7	1/8	11	20,5	34,5	25	9
35391620	7	1/4	11,5	21	34,5	25	9

# RACCORDI STANDARD - ACCESSORI - SILENZIATORI

STANDARD FITTINGS - ACCESSORIES - SILENCERS

**L PORTAGOMMA  
MASCHIO 120° RAGGIATO**  
ELBOW HOSE CONNECTOR 120°  
MALE RADIUS

**3540**

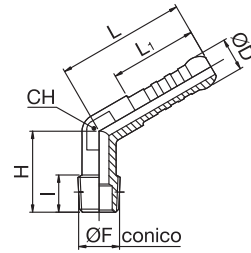

ARTICOLO	D	F	I	H	L	L1	CH
35401570	6	1/8	8	18,5	29,5	20	8
35401610	7	1/8	8	18,5	29,5	20	8

**L PORTAGOMMA  
FEMMINA 120° RAGGIATO**  
ELBOW HOSE CONNECTOR 120°  
FEMALE RADIUS

**3541**

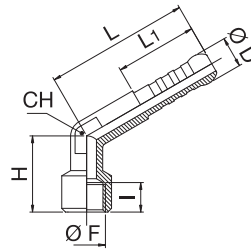

ARTICOLO	D	F	I	H	L	L1	CH
35411570	6	1/8	8	19,5	38	20	8
35411610	7	1/8	8	19,5	38	20	8

**L PORTAGOMMA  
MASCHIO 120° SERIE LUNGA**  
ELBOW HOSE CONNECTOR 120°  
MALE LONG SERIES

**3543**

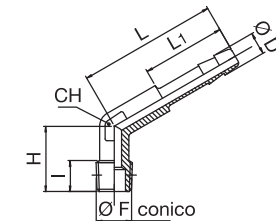

ARTICOLO	D	F	I	H	L	L1	CH
35431570	6	1/8	8	18,5	38	23	8
35431610	7	1/8	8	18,5	38	23	8

**T M.M.M.  
TEE M.M.M.**

**3550**

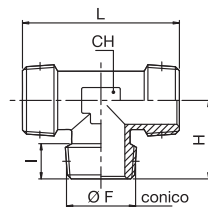

ARTICOLO	F	I	H	L	CH
35500800	1/8	8	18,5	37	10
35501700	1/4	11	23,5	47	13
35502600	3/8	11,5	26	52	17
35503500	1/2	14	31	62	21
35504900	3/4	16	33	66,4	25
35505300	1"	17,5	39	78	30

**T M.M.M. GIALLO  
TEE M.M.M. NOT NICKEL PLATED**

**D3550**

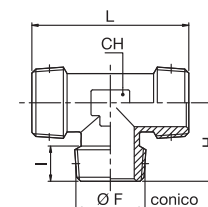

ARTICOLO	F	I	H	L	CH
D35500800	1/8	8	18,5	37	10
D35501700	1/4	11	23,5	47	13
D35502600	3/8	11,5	26	52	17
D35503500	1/2	14	31	62	21
D35504900	3/4	16	33	66,4	25
D35505300	1"	17	39	78	30



# RACCORDI STANDARD - ACCESSORI - SILENZIATORI

STANDARD FITTINGS - ACCESSORIES - SILENCERS

**T M.F.M.**  
TEE M.F.M.



**3560**

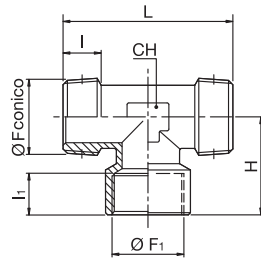

ARTICOLO	F	F1	I	I1	H	L	CH
35600800	1/8	1/8	8	8	21	37	10
35601700	1/4	1/4	11	11	25,5	47	13
35602600	3/8	3/8	11,5	11,5	28	52	17
35603500	1/2	1/2	14	15	33,5	62	21
35604900	3/4	3/4	16	16,5	36,5	66,4	25
35605300	1"	1"	17,5	19	45	78	30

**T M.F.M. GIALLO**  
TEE M.F.M. NOT NICKEL PLATED



**D3560**

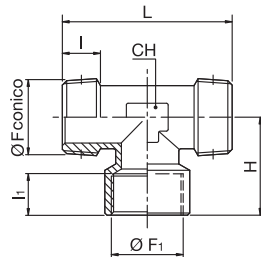

ARTICOLO	F	F1	I	I1	H	L	CH
D35600800	1/8	1/8	8	8	21	37	10
D35601700	1/4	1/4	11	11	25,5	47	13
D35602600	3/8	3/8	11,5	11,5	28	52	17
D35603500	1/2	1/2	14	15	33,5	62	21
D35604900	3/4	3/4	16	16,5	36,5	66,4	25
D35605300	1"	1"	17,5	19	45	78	30

**T M.F.F.**  
TEE M.F.F.



**3570**

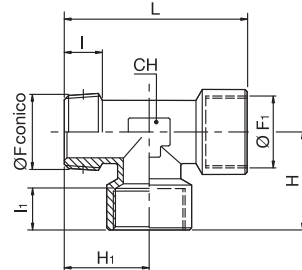

ARTICOLO	F	F1	I	I1	H	H1	L	CH
35700300	M5	M5	4	5	11	12	22,5	9
35700800	1/8	1/8	8	8	21	18,5	39,5	10
35701700	1/4	1/4	11	11	25,5	23,5	49	13
35702600	3/8	3/8	11,5	11,5	28	26	54	17
35703500	1/2	1/2	14	14	33,5	31	64,5	21
35704900	3/4	3/4	16	16,5	36,5	33	69,5	25
35705300	1"	1"	17,5	19	45	39	84	30

**T M.F.F. GIALLO**  
TEE M.F.F. NOT NICKEL PLATED



**D3570**

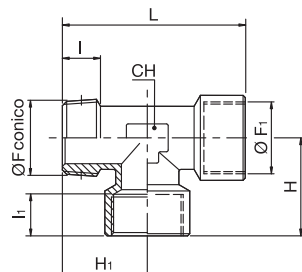

ARTICOLO	F	F1	I	I1	H	H1	L	CH
D35700300	M5	M5	4	5	11	12	22,5	9
D35700800	1/8	1/8	8	8	21	18,5	39,5	10
D35701700	1/4	1/4	11	11	25,5	23,5	49	13
D35702600	3/8	3/8	11,5	11,5	28	26	54	17
D35703500	1/2	1/2	14	14	33,5	31	64,5	21
D35704900	3/4	3/4	16	16,5	36,5	33	69,5	25
D35705300	1"	1"	17,5	19	45	39	84	30

**T F.F.F.**  
TEE F.F.F.



**3580**

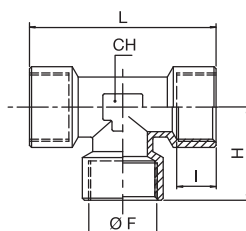

ARTICOLO	F	I	H	L	CH
35800300	M5	5	11	22	9
35800800	1/8	8	21	42	10
35801700	1/4	11	25,5	51	13
35802600	3/8	11,5	28	56	17
35803500	1/2	14	33,5	67	21
35804900	3/4	16,5	36,5	73	25
35805300	1"	19	45	90	30

# RACCORDI STANDARD - ACCESSORI - SILENZIATORI

STANDARD FITTINGS - ACCESSORIES - SILENCERS

**T F.F.F. GIALLO**  
TEE F.F.F. NOT NICKEL PLATED



**D3580**

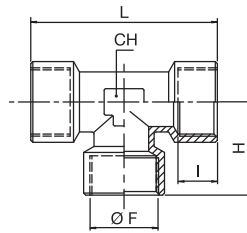

ARTICOLO	F	I	H	CH
D35800300	M5	5	11	22 9
D35800800	1/8	8	21	42 10
D35801700	1/4	11	25,5	51 13
D35802600	3/8	11,5	28	56 17
D35803500	1/2	14	33,5	67 21
D35804900	3/4	16,5	36,5	73 25
D35805300	1"	19	45	90 30

**T F.M.F.**  
TEE F.M.F.



**3590**

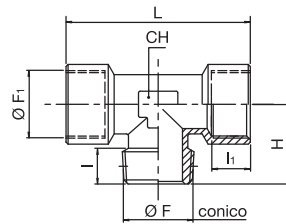

ARTICOLO	F	F1	I	I1	H	L	CH
35900300	M5	M5	4	5	11,5	22	9
35900800	1/8	1/8	8	8	18,5	42	10
35901700	1/4	1/4	11	11	23,5	51	13
35902600	3/8	3/8	11,5	11,5	26	56	17
35903500	1/2	1/2	14	14	31	67	21
35904900	3/4	3/4	16	16,5	33	73	25
35905300	1"	1"	17,5	19	39	90	30

**T F.M.F. GIALLO**  
TEE F.M.F. NOT NICKEL PLATED



**D3590**

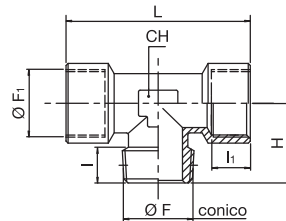

ARTICOLO	F	F1	I	I1	H	L	CH
D35900300	M5	M5	4	5	11,5	22	9
D35900800	1/8	1/8	8	8	18,5	42	10
D35901700	1/4	1/4	11	11	23,5	51	13
D35902600	3/8	3/8	11,5	11,5	26	56	17
D35903500	1/2	1/2	14	14	31	67	21
D35904900	3/4	3/4	16	16,5	33	73	25
D35905300	1"	1"	17,5	19	39	90	30

**T M.M.F.**  
TEE M.M.F.



**3600**

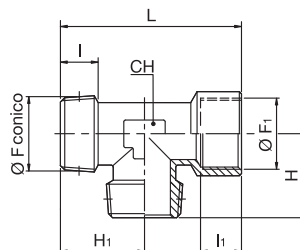

ARTICOLO	F	F1	I	I1	H	H1	L	CH
36000800	1/8	1/8	8	8	18,5	18,5	39,5	10
36001700	1/4	1/4	11	11	23,5	23,5	49	13
36002600	3/8	3/8	11,5	11,5	26	26	54	17
36003500	1/2	1/2	14	14	31	31	64,5	21
36004900	3/4	3/4	16	16,5	33	33	69,5	25
36005300	1"	1"	17,5	19	39	39	84	30

**T M.M.F. GIALLO**  
TEE M.M.F. NOT NICKEL PLATED





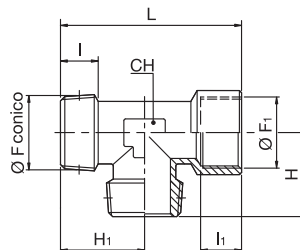





**D3600**

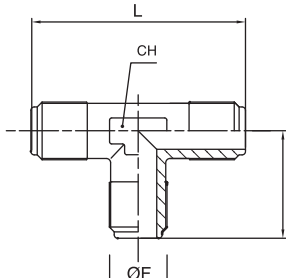

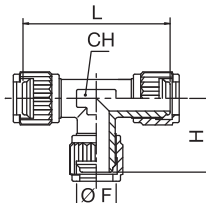
ARTICOLO	F	F1	I	I1	H	H1	L	CH
D36000800	1/8	1/8	8	8	18,5	18,5	39,5	10
D36001700	1/4	1/4	11	11	23,5	23,5	49	13
D36002600	3/8	3/8	11,5	11,5	26	26	54	17
D36003500	1/2	1/2	14	14	31	31	64,5	21
D36004900	3/4	3/4	16	16,5	33	33	69,5	25
D36005300	1"	1"	17,5	19	39	39	84	30

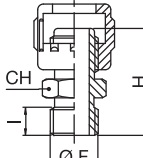
# RACCORDI STANDARD - ACCESSORI - SILENZIATORI

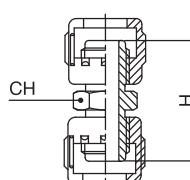
STANDARD FITTINGS - ACCESSORIES - SILENCERS

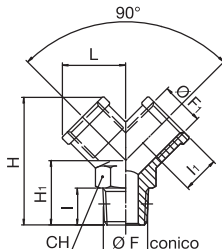
<p><b>T ATTACCO BAIONETTA</b> TEE BAYONET</p> 	<p><b>3605</b></p> 	<table border="1"> <thead> <tr> <th>ARTICOLO</th> <th>F</th> <th>H</th> <th>L</th> <th>CH</th> </tr> </thead> <tbody> <tr> <td>36051700</td> <td>1/4</td> <td>25,3</td> <td>50,6</td> <td>13</td> </tr> <tr><td> </td><td> </td><td> </td><td> </td><td> </td></tr> <tr><td> </td><td> </td><td> </td><td> </td><td> </td></tr> <tr><td> </td><td> </td><td> </td><td> </td><td> </td></tr> <tr><td> </td><td> </td><td> </td><td> </td><td> </td></tr> <tr><td> </td><td> </td><td> </td><td> </td><td> </td></tr> <tr><td> </td><td> </td><td> </td><td> </td><td> </td></tr> <tr><td> </td><td> </td><td> </td><td> </td><td> </td></tr> <tr><td> </td><td> </td><td> </td><td> </td><td> </td></tr> <tr><td> </td><td> </td><td> </td><td> </td><td> </td></tr> <tr><td> </td><td> </td><td> </td><td> </td><td> </td></tr> </tbody> </table>	ARTICOLO	F	H	L	CH	36051700	1/4	25,3	50,6	13																																																																																																																													
ARTICOLO	F	H	L	CH																																																																																																																																					
36051700	1/4	25,3	50,6	13																																																																																																																																					
<p><b>T ATTACCO BAIONETTA / GHIERA</b> TEE BAYONET + MILLED NUT</p> 	<p><b>3610</b></p> 	<table border="1"> <thead> <tr> <th>ARTICOLO</th> <th>F</th> <th>H</th> <th>L</th> <th>CH</th> </tr> </thead> <tbody> <tr> <td>36101700</td> <td>1/4</td> <td>25,3</td> <td>50,6</td> <td>13</td> </tr> <tr><td> </td><td> </td><td> </td><td> </td><td> </td></tr> <tr><td> </td><td> </td><td> </td><td> </td><td> </td></tr> <tr><td> </td><td> </td><td> </td><td> </td><td> </td></tr> <tr><td> </td><td> </td><td> </td><td> </td><td> </td></tr> <tr><td> </td><td> </td><td> </td><td> </td><td> </td></tr> <tr><td> </td><td> </td><td> </td><td> </td><td> </td></tr> <tr><td> </td><td> </td><td> </td><td> </td><td> </td></tr> <tr><td> </td><td> </td><td> </td><td> </td><td> </td></tr> <tr><td> </td><td> </td><td> </td><td> </td><td> </td></tr> <tr><td> </td><td> </td><td> </td><td> </td><td> </td></tr> </tbody> </table>	ARTICOLO	F	H	L	CH	36101700	1/4	25,3	50,6	13																																																																																																																													
ARTICOLO	F	H	L	CH																																																																																																																																					
36101700	1/4	25,3	50,6	13																																																																																																																																					
<p><b>DIRITTO MASCHIO</b> <b>ATTACCO BAIONETTA / GHIERA</b> STRAIGHT MALE BAYONET + MILLED NUT</p> 	<p><b>3611</b></p> 	<table border="1"> <thead> <tr> <th>ARTICOLO</th> <th>F</th> <th>I</th> <th>H</th> <th>CH</th> </tr> </thead> <tbody> <tr> <td>36111700</td> <td>1/4</td> <td>10</td> <td>28,5</td> <td>15</td> </tr> <tr> <td>36112600</td> <td>3/8</td> <td>10</td> <td>28,5</td> <td>17</td> </tr> <tr><td> </td><td> </td><td> </td><td> </td><td> </td></tr> <tr><td> </td><td> </td><td> </td><td> </td><td> </td></tr> <tr><td> </td><td> </td><td> </td><td> </td><td> </td></tr> <tr><td> </td><td> </td><td> </td><td> </td><td> </td></tr> <tr><td> </td><td> </td><td> </td><td> </td><td> </td></tr> <tr><td> </td><td> </td><td> </td><td> </td><td> </td></tr> <tr><td> </td><td> </td><td> </td><td> </td><td> </td></tr> <tr><td> </td><td> </td><td> </td><td> </td><td> </td></tr> <tr><td> </td><td> </td><td> </td><td> </td><td> </td></tr> </tbody> </table>	ARTICOLO	F	I	H	CH	36111700	1/4	10	28,5	15	36112600	3/8	10	28,5	17																																																																																																																								
ARTICOLO	F	I	H	CH																																																																																																																																					
36111700	1/4	10	28,5	15																																																																																																																																					
36112600	3/8	10	28,5	17																																																																																																																																					
<p><b>DIRITTO INTERMEDIO</b> <b>ATTACCO BAIONETTA / GHIERA</b> STRAIGHT CONNECTOR BAYONET + MILLED NUT</p> 	<p><b>3615</b></p> 	<table border="1"> <thead> <tr> <th>ARTICOLO</th> <th>-</th> <th>H</th> <th>CH</th> </tr> </thead> <tbody> <tr> <td>36151700</td> <td>1/4</td> <td>32</td> <td>15</td> </tr> <tr><td> </td><td> </td><td> </td><td> </td></tr> <tr><td> </td><td> </td><td> </td><td> </td></tr> <tr><td> </td><td> </td><td> </td><td> </td></tr> <tr><td> </td><td> </td><td> </td><td> </td></tr> <tr><td> </td><td> </td><td> </td><td> </td></tr> <tr><td> </td><td> </td><td> </td><td> </td></tr> <tr><td> </td><td> </td><td> </td><td> </td></tr> <tr><td> </td><td> </td><td> </td><td> </td></tr> <tr><td> </td><td> </td><td> </td><td> </td></tr> <tr><td> </td><td> </td><td> </td><td> </td></tr> </tbody> </table>	ARTICOLO	-	H	CH	36151700	1/4	32	15																																																																																																																															
ARTICOLO	-	H	CH																																																																																																																																						
36151700	1/4	32	15																																																																																																																																						
<p><b>Y.F.M.F.</b> Y.F.M.F.</p> 	<p><b>3620</b></p> 	<table border="1"> <thead> <tr> <th>ARTICOLO</th> <th>F</th> <th>F1</th> <th>I</th> <th>I1</th> <th>H</th> <th>H1</th> <th>L</th> <th>CH</th> </tr> </thead> <tbody> <tr> <td>36200800</td> <td>1/8</td> <td>1/8</td> <td>8</td> <td>8</td> <td>32</td> <td>16</td> <td>14,5</td> <td>13</td> </tr> <tr> <td>36201700</td> <td>1/4</td> <td>1/4</td> <td>11</td> <td>11</td> <td>38</td> <td>20</td> <td>18</td> <td>17</td> </tr> <tr> <td>36202600</td> <td>3/8</td> <td>3/8</td> <td>11,5</td> <td>11,5</td> <td>42,5</td> <td>22</td> <td>20,5</td> <td>20</td> </tr> <tr> <td>36203500</td> <td>1/2</td> <td>1/2</td> <td>14</td> <td>14</td> <td>53</td> <td>27</td> <td>26,5</td> <td>25</td> </tr> <tr><td> </td><td> </td><td> </td><td> </td><td> </td><td> </td><td> </td><td> </td><td> </td></tr> <tr><td> </td><td> </td><td> </td><td> </td><td> </td><td> </td><td> </td><td> </td><td> </td></tr> <tr><td> </td><td> </td><td> </td><td> </td><td> </td><td> </td><td> </td><td> </td><td> </td></tr> <tr><td> </td><td> </td><td> </td><td> </td><td> </td><td> </td><td> </td><td> </td><td> </td></tr> <tr><td> </td><td> </td><td> </td><td> </td><td> </td><td> </td><td> </td><td> </td><td> </td></tr> <tr><td> </td><td> </td><td> </td><td> </td><td> </td><td> </td><td> </td><td> </td><td> </td></tr> <tr><td> </td><td> </td><td> </td><td> </td><td> </td><td> </td><td> </td><td> </td><td> </td></tr> <tr><td> </td><td> </td><td> </td><td> </td><td> </td><td> </td><td> </td><td> </td><td> </td></tr> <tr><td> </td><td> </td><td> </td><td> </td><td> </td><td> </td><td> </td><td> </td><td> </td></tr> <tr><td> </td><td> </td><td> </td><td> </td><td> </td><td> </td><td> </td><td> </td><td> </td></tr> </tbody> </table>	ARTICOLO	F	F1	I	I1	H	H1	L	CH	36200800	1/8	1/8	8	8	32	16	14,5	13	36201700	1/4	1/4	11	11	38	20	18	17	36202600	3/8	3/8	11,5	11,5	42,5	22	20,5	20	36203500	1/2	1/2	14	14	53	27	26,5	25																																																																																										
ARTICOLO	F	F1	I	I1	H	H1	L	CH																																																																																																																																	
36200800	1/8	1/8	8	8	32	16	14,5	13																																																																																																																																	
36201700	1/4	1/4	11	11	38	20	18	17																																																																																																																																	
36202600	3/8	3/8	11,5	11,5	42,5	22	20,5	20																																																																																																																																	
36203500	1/2	1/2	14	14	53	27	26,5	25																																																																																																																																	

# RACCORDI STANDARD - ACCESSORI - SILENZIATORI

STANDARD FITTINGS - ACCESSORIES - SILENCERS

**Y F.M.F. GIALLO**  
Y F.M.F. NOT NICKEL PLATED

**D3620**

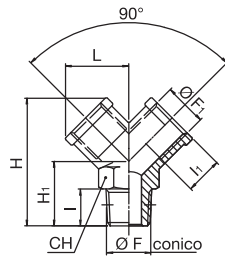

ARTICOLO	F	F1	I	I1	H	H1	L	CH
D36200800	1/8	1/8	8	8	32	16	14,5	13
D36201700	1/4	1/4	11	11	38	20	18	17
D36202600	3/8	3/8	11,5	11,5	42,5	22	20,5	20
D36203500	1/2	1/2	14	14	53	27	26,5	25

**Y F.F.F.**  
Y F.F.F.

**3630**

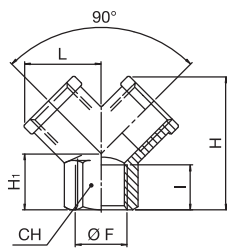

ARTICOLO	F	I	H	H1	L	CH
36300800	1/8	8	26,5	12	14,5	13
36301700	1/4	11	32	14	18	17
36302600	3/8	11,5	37	16	20,5	20
36303500	1/2	14	45	19	26,5	25

**Y F.F.F. GIALLO**  
Y F.F.F. NOT NICKEL PLATED

**D3630**

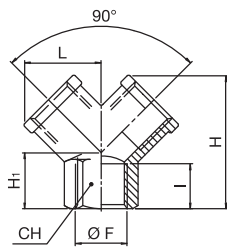

ARTICOLO	F	I	H	H1	L	CH
D36300800	1/8	8	26,5	12	14,5	13
D36301700	1/4	11	32	14	18	17
D36302600	3/8	11,5	37	16	20,5	20
D36303500	1/2	14	45	19	26,5	25

**CROCE M.F.F.F.**  
CROSS M.F.F.F.

**3650**

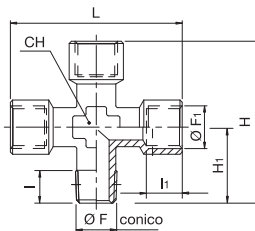

ARTICOLO	F	F1	I	I1	H	H1	L	CH
36500900	1/8	1/8	8	8	39,5	18,5	42	10
36501900	1/4	1/4	11	11	49	23,5	51	13
36502900	3/8	3/8	11,5	11,5	54	26	56	17
36503900	1/2	1/2	14	14	64,5	31	67	21

**CROCE M.F.F.F. GIALLO**  
CROSS M.F.F.F. NOT NICKEL PLATED

**D3650**

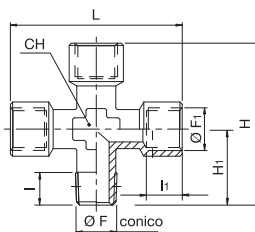

ARTICOLO	F	F1	I	I1	H	H1	L	CH
D36500900	1/8	1/8	8	8	39,5	18,5	42	10
D36501900	1/4	1/4	11	11	49	23,5	51	13
D36502900	3/8	3/8	11,5	11,5	54	26	56	17
D36503900	1/2	1/2	14	14	64,5	31	67	21

**RACCORDI STANDARD - ACCESSORI - SILENZIATORI**

STANDARD FITTINGS - ACCESSORIES - SILENCERS

**CROCE M.F.M.F.**  
CROSS M.F.M.F.

**3655**

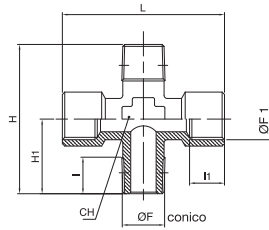

ARTICOLO	F	F1	I	I1	H	H1	L	CH
36551900	1/4	1/4	11	11	47	23,5	51	13

**CROCE F.F.F.F.**  
CROSS F.F.F.F.

**3660**

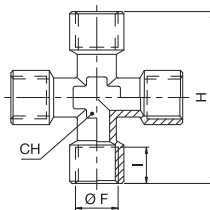

ARTICOLO	F	I	H	CH
36600800	1/8	8	42	10
36601700	1/4	11	51	13
36602600	3/8	11,5	56	17
36603500	1/2	14	67	21

**CROCE F.F.F.F. GIALLO**  
CROSS F.F.F.F. NOT NICKEL PLATED

**D3660**

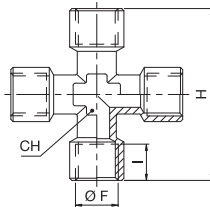

ARTICOLO	F	I	H	CH
D36600800	1/8	8	42	10
D36601700	1/4	11	51	13
D36602600	3/8	11,5	56	17
D36603500	1/2	14	67	21

**GHIERA FOLLE**  
RING NUT

**3665**

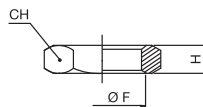

ARTICOLO	F	H	CH
36650800	1/8	4,5	14
36651700	1/4	5	17
36652600	3/8	5,5	19
36653500	1/2	6	24
36654900	3/4	6	32
36655300	1"	8	38

**GHIERA PASSAPARETE METRICA**  
BULKHEAD LOCK NUT

**3666**

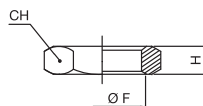

ARTICOLO	F	H	CH
36662800	M16X1,5	5	22
36662810	M20X1,5	6	27
36662820	M26X1,5	7	32
36662830	M28X1,5	7	36



# RACCORDI STANDARD - ACCESSORI - SILENZIATORI

STANDARD FITTINGS - ACCESSORIES - SILENCERS

**BLOCCHETTO ALLUMINIO**  
4 WAY DISTRIBUTION FRAME

**3670**

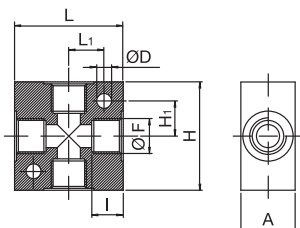
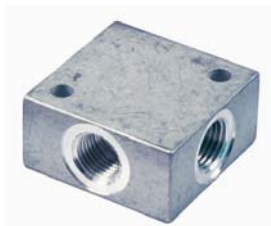

ARTICOLO	F	I	H	H1	L	L1	D	A
36700800	1/8	8	25	8,5	25	8,5	4,5	16
36701700	1/4	11	40	13	40	13	5,5	20
36702600	3/8	11,5	50	17	50	17	5,5	25
36703500	1/2	14	50	17	50	17	5,5	30

**BLOCCHETTO ALLUMINIO ANODIZZATO**  
4 WAY DISTRIBUTION FRAME ANODIZED

**3670-1**

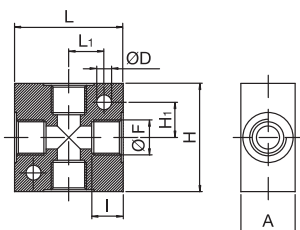

ARTICOLO	F	I	H	H1	L	L1	D	A
36700801	1/8	8	25	8,5	25	8,5	4,5	16
36701701	1/4	11	40	13	40	13	5,5	20
36702601	3/8	11,5	50	17	50	17	5,5	25
36703501	1/2	14	50	17	50	17	5,5	30

**RIPARTITORE ALLUMINIO SINGOLO**  
SINGLE DISTRIBUTION FRAME

**3671**

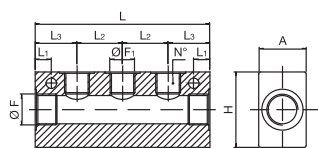

ARTICOLO	F	F1	A	H	L1	L2	L3	L	N°
36715070	1/4	1/8	20	30	4,5	18	18	54	2
36715080	1/4	1/8	20	30	4,5	18	18	72	3
36715090	1/4	1/8	20	30	4,5	18	18	90	4
36715100	1/4	1/8	20	30	4,5	18	18	108	5
36715210	3/8	1/4	25	40	8,5	24	22	68	2
36715220	3/8	1/4	25	40	8,5	24	22	92	3
36715230	3/8	1/4	25	40	8,5	24	22	116	4
36715240	3/8	1/4	25	40	8,5	24	22	140	5

**RIPARTITORE ALLUMINIO DOPPIO**  
DOUBLE DISTRIBUTION FRAME

**3672**

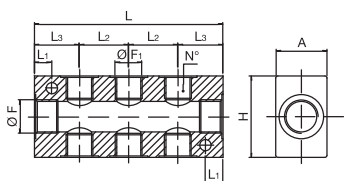

ARTICOLO	F	F1	A	H	L1	L2	L3	L	N°
36725070	1/4	1/8	20	30	4,5	18	18	54	2+2
36725080	1/4	1/8	20	30	4,5	18	18	72	3+3
36725090	1/4	1/8	20	30	4,5	18	18	90	4+4
36725100	1/4	1/8	20	30	4,5	18	18	108	5+5
36725210	3/8	1/4	25	40	8,5	24	22	68	2+2
36725220	3/8	1/4	25	40	8,5	24	22	92	3+3
36725230	3/8	1/4	25	40	8,5	24	22	116	4+4
36725240	3/8	1/4	25	40	8,5	24	22	140	5+5

# RACCORDI STANDARD - ACCESSORI - SILENZIATORI

STANDARD FITTINGS - ACCESSORIES - SILENCERS

**NIPLO CONICO**  
NIPPLE CONICAL

**3680**

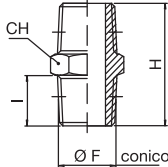
ARTICOLO	F	I	H	CH
36800800	1/8	8	20,5	12
36801700	1/4	11	27	14
36802600	3/8	11,5	28	17
36803500	1/2	14	33,5	22
36804900	3/4	16,5	39,5	27
36805300	1"	19	45,5	34

**NIPLO CILINDRICO**  
NIPPLE CYLINDRICAL

**3681**

ARTICOLO	F	I	H	CH
36810300	M5	4	11,5	8
36810800	1/8	6	16,5	14
36811700	1/4	8	21	17
36812600	3/8	9	23	19
36813500	1/2	10	25,5	24
36814900	3/4	11	28,5	30
36815300	1"	14	35	36

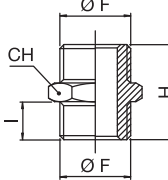
**NIPLO CILINDRICO CON OR**  
NIPPLE CYLINDRICAL WITH O-RING

**3682**

ARTICOLO	F	I	H	CH
36820800	1/8	6,5	17,5	14
36821700	1/4	8	21	17
36822600	3/8	9	23	20
36823500	1/2	10	26	24

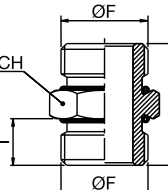
**NIPLO CONICO GIREVOLE 3 PEZZI**  
SWIVEL NIPPLE CONICAL 3 PIECES

**3684**

ARTICOLO	F	F1	H	I	A	I1	CH	CH1
36840900	1/8	1/8	28,5	9	9	9	15	4
36841900	1/4	1/4	34	11	10	11	19	5
36842900	3/8	3/8	35,5	11,5	10	11,5	22	8
36843900	1/2	1/2	41	14	11	14	27	10

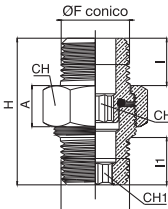
**NIPLO RIDUZIONE CONICO**  
REDUCING NIPPLE CONICAL

**3685**

ARTICOLO	F	F1	I	I1	H	CH
36851000	1/8	1/4	8	11	24	14
36851100	1/8	3/8	8	11,5	24,5	17
36852000	1/4	3/8	11	11,5	27,5	17
36852100	1/4	1/2	11	14	30,5	22
36853000	3/8	1/2	11,5	14	31	22
36854000	1/2	3/4	14	16,5	37	27
36855000	3/4	1"	16,5	19	42,5	34

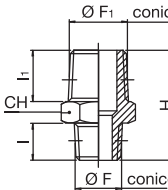
**NIPLO RIDUZIONE CILINDRICO**  
REDUCING NIPPLE CYLINDRICAL

**3686**

ARTICOLO	F	F1	I	I1	H	CH
36860400	M5	1/8	4	6	14,5	14
36861000	1/8	1/4	6	8	19	17
36861100	1/8	3/8	6	9	20	19
36862000	1/4	3/8	8	9	22	19
36862100	1/4	1/2	8	10	23,5	24
36863000	3/8	1/2	9	10	24,5	24
36864000	1/2	3/4	10	11	27,5	30
36865000	3/4	1"	12	11	30	36

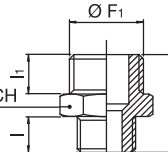
# RACCORDI STANDARD - ACCESSORI - SILENZIATORI

STANDARD FITTINGS - ACCESSORIES - SILENCERS

**NIPPO RIDUZIONE  
CILINDRICO CON OR**  
REDUCING NIPPLE CYLINDRICAL  
WITH O-RING



**3687**

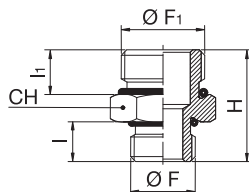

ARTICOLO	F	F1	I	I1	H	CH
36871000	1/8	1/4	6,5	8	19,5	17
36871100	1/8	3/8	6,5	9	21	20
36872000	1/4	3/8	8	9	22	20
36872100	1/4	1/2	8	10	24	24
36873000	3/8	1/2	9	10	25	24

**MAGGIORAZIONE MASCHIO  
CONICA-FEMMINA**  
EXSTENSION MALE CONICAL-FEMALE



**3690**

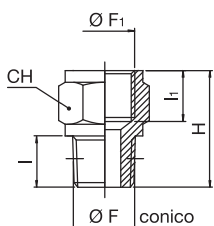

ARTICOLO	F	F1	I	I1	H	CH
36900900	1/8	1/8	8	8	18	14
36901000	1/8	1/4	8	11	21,5	17
36901100	1/8	3/8	8	11,5	22,5	22
36901900	1/4	1/4	11	11	24,5	17
36902000	1/4	3/8	11	11,5	25,5	22
36902100	1/4	1/2	11	14	29	24
36902900	3/8	3/8	11,5	11,5	26	22
36903000	3/8	1/2	11,5	14	29,5	24
36903900	1/2	1/2	14	14	32	26
36904000	1/2	3/4	14	16,5	35	32
36904100	1/2	1"	14	19	37,5	38

**MAGGIORAZIONE MASCHIO  
CILINDRICA-FEMMINA**  
EXSTENSION MALE CYLINDRICAL-FEMALE



**3691**

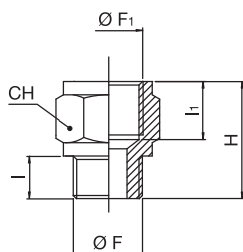

ARTICOLO	F	F1	I	I1	H	CH
36910400	M5	1/8	4	8	14,5	14
36910900	1/8	1/8	6	8	16,5	14
36911000	1/8	1/4	6	11	19,5	17
36911100	1/8	3/8	6	11,5	20,5	22
36911900	1/4	1/4	8	11	21,5	17
36912000	1/4	3/8	8	11,5	22,5	22
36912100	1/4	1/2	8	14	26	24
36912900	3/8	3/8	9	11,5	23,5	22
36913000	3/8	1/2	9	14	27	24
36913900	1/2	1/2	10	14	28	26
36914000	1/2	3/4	10	16,5	30	32

**MAGGIORAZIONE MASCHIO  
CILINDRICA CON OR-FEMMINA**  
EXSTENSION MALE CYLINDRICAL WITH  
O-RING-FEMALE



**3692**

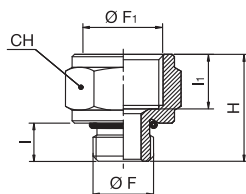

ARTICOLO	F	F1	I	I1	H	CH
36920900	1/8	1/8	6,5	8,5	17	14
36921000	1/8	1/4	6,5	11	20	17
36921100	1/8	3/8	6,5	11,5	21	22
36921900	1/4	1/4	8	11	21,5	17
36922000	1/4	3/8	8	11,5	22,5	22
36922100	1/4	1/2	9	14	26	24
36922900	3/8	3/8	9	11,5	23,5	22
36923000	3/8	1/2	9	14	27	24

**NIPPO CONICO GIREVOLE**  
SWIVEL NIPPLE CONICAL



**3693**

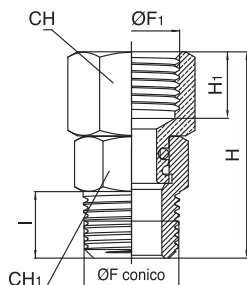

ARTICOLO	F	F1	I	I1	H	CH	CH1
36930800	1/8	1/8	8	8	28	12	13
36931700	1/4	1/4	11	11	34	14	16
36932600	1/8	3/8	11,5	11,5	35,5	17	19

# RACCORDI STANDARD - ACCESSORI - SILENZIATORI

STANDARD FITTINGS - ACCESSORIES - SILENCERS

**NIPPO CILINDRICO  
GIREVOLE CON OR**  
SWIVEL NIPPLE CYLINDRICAL  
WITH O-RING



**3694**

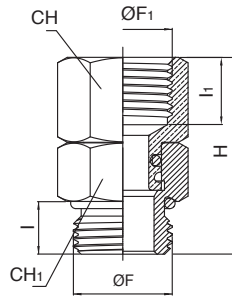

ARTICOLO	F	F1	I	I1	H	CH	CH1
36940800	1/8	1/8	6,5	8	27	13	13
36941700	1/4	1/4	8	11	32	16	16
36942600	3/8	3/8	9	11,5	33,5	19	19

**RIDUZIONE PROLUNGA M.F.**  
EXTENSION CYLINDRICAL M.F.



**3695**

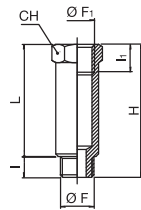

ARTICOLO	F	F1	I	I1	L	H	CH
36950816	1/8	1/8	6	8	16	22	14
36950836	1/8	1/8	6	8	36	42	14
36950845	1/8	1/8	6	8	45	51	14
36951727	1/4	1/4	8	11	27	35	17
36951743	1/4	1/4	8	11	43	51	17

**PASSAPARETE F.F.**  
BULKHEAD F.F.



**3696**

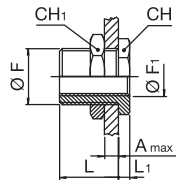

ARTICOLO	F	F1	A <sub>MAX</sub>	L	L1	CH	CH1
36962790	M10X1	M5	7	10,5	3,5	14	14
36962800	M16X1,5	1/8	10	14	4	19	22
36962810	M20X1,5	1/4	16	21	4	24	27
36962820	M26X1,5	3/8	15	21	5	30	32
36962830	M28X1,5	1/2	21	27	6	32	36

**RIDUZIONE CONICA M.F.**  
REDUCER ADAPTOR CONICAL M.F.



**3700**

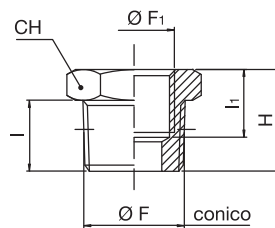

ARTICOLO	F	F1	I	I1	H	CH
37001800	1/4	1/8	11	8	16	14
37002700	3/8	1/8	11,5	8	16,5	17
37002800	3/8	1/4	11,5	11	16,5	17
37003600	1/2	1/8	14	8	19,5	22
37003700	1/2	1/4	14	11	19,5	22
37003800	1/2	3/8	14	11,5	19,5	22
37004700	3/4	3/8	16,5	11,5	23	27
37004800	3/4	1/2	16,5	14	23	27
37005100	1"	1/2	19	14	27	34
37005400	1"	3/4	19	16,5	27	34

**RIDUZIONE CILINDRICA M.F.**  
REDUCER ADAPTOR CYLINDRICAL M.F.



**3705**

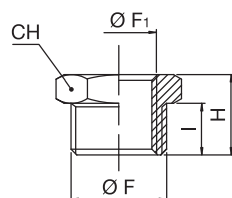

ARTICOLO	F	F1	I	H	CH
37050400	1/8	M5	6	10,5	14
37051800	1/4	1/8	8	13	17
37052700	3/8	1/8	9	14	19
37052800	3/8	1/4	9	14	19
37053600	1/2	1/8	10	15,5	24
37053700	1/2	1/4	10	15,5	24
37053800	1/2	3/8	10	15,5	24
37054700	3/4	3/8	11	17,5	30
37054800	3/4	1/2	11	17,5	30
37055100	1"	1/2	11,5	18,5	36
37055400	1"	3/4	11,5	18,5	36

# RACCORDI STANDARD - ACCESSORI - SILENZIATORI

STANDARD FITTINGS - ACCESSORIES - SILENCERS

**RIDUZIONE CILINDRICA M.F. CON OR**  
REDUCER ADAPTOR CYLINDRICAL M.F. WITH O-RING

**3706**

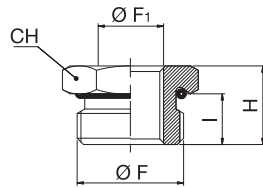

ARTICOLO	F	F1	I	H	CH
37060400	1/8	M5	6,5	11	14
37061800	1/4	1/8	8	13	17
37062700	3/8	1/8	9	14	20
37062800	3/8	1/4	9	14	20
37063600	1/2	1/8	10	15,5	24
37063700	1/2	1/4	10	15,5	24
37063800	1/2	3/8	10	15,5	24

**RIDUZIONE CILINDRICA M.F. (A SCOMPARS)**  
HEXAGONAL HIDDEN REDUCER CYLINDRICAL M.F.

**3707**

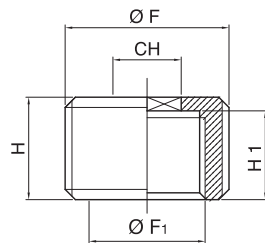

ARTICOLO	F	F1	I	H	CH
37071800	1/4	1/8	9	7	6
37072800	3/8	1/4	9	7	8
37073800	1/2	3/8	11	9	10
37074800	3/4	1/2	13	11	12
37075400	1	3/4	15	12,5	17

**MANICOTTO**  
SLEEVE

**3710**

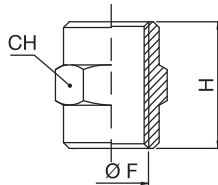

ARTICOLO	F	H	CH
37100300	M5	11	8
37100800	1/8	15	14
37101700	1/4	22	17
37102600	3/8	23	22
37103500	1/2	28	26
37104900	3/4	32	32
37105300	1"	35	38

**MANICOTTO RIDUZIONE**  
REDUCING SLEEVE

**3715**

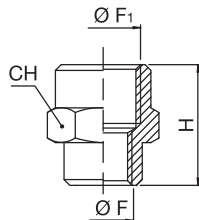

ARTICOLO	F	F1	H	CH
37150400	M5	1/8	13,5	14
37151000	1/8	1/4	19	17
37151100	1/8	3/8	20	22
37151200	1/8	1/2	24	24
37152000	1/4	3/8	22,5	22
37152100	1/4	1/2	26	24
37153000	3/8	1/2	26	24
37154800	1/2	3/4	30	32

**TAPPO MASCHIO CILINDRICO CON OR**  
PLUG MALE CYLINDRICAL WITH O-RING

**3719**

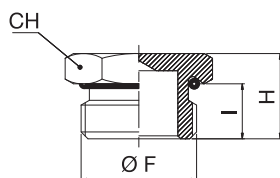

ARTICOLO	F	I	H	CH
37190800	1/8	6,5	10,5	14
37191700	1/4	8	12,5	17
37192600	3/8	9	13,5	20
37193500	1/2	10	15,5	24



# RACCORDI STANDARD - ACCESSORI - SILENZIATORI

STANDARD FITTINGS - ACCESSORIES - SILENCERS

**TAPPO MASCHIO  
CILINDRICO CON OR VITON**  
PLUG MALE CYLINDRICAL  
WITH O-RING VITON



**3719V**

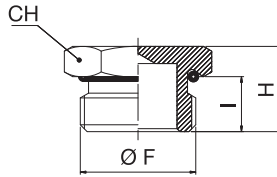

ARTICOLO	F	I	H	CH
37190800V	1/8	6,5	10,5	14
37191700V	1/4	8	12,5	17
37192600V	3/8	9	13,5	20
37193500V	1/2	10	15,5	24

**TAPPO MASCHIO CILINDRICO**  
PLUG MALE CYLINDRICAL



**3720**

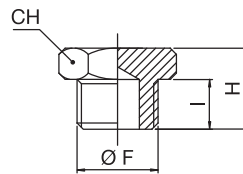

ARTICOLO	F	I	H	CH
37200300	M5	4	7	8
37200800	1/8	6	10	14
37201700	1/4	8	12,5	17
37202600	3/8	9	13,5	19
37203500	1/2	10	15,5	24
37204900	3/4	11	16,5	30
37205300	1"	13	19	38

**TAPPO MASCHIO CILINDRICO  
CON BRUGOLA**  
ALLEN KEY PLUG



**3721**

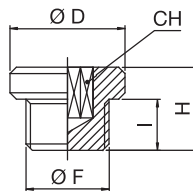

ARTICOLO	F	I	H	D	CH
37210300	M5	4	6,5	8	2,5
37210800	1/8	6	9,5	15	5
37211700	1/4	8	11,5	18	6
37212600	3/8	9	13	21	8
37213500	1/2	10	14,5	25	10
37214900	3/4	11	15,5	31	14
37215300	1"	13	17,5	38	17

**TAPPO MASCHIO CILINDRICO  
CON BRUGOLA CON OR**  
ALLEN KEY PLUG WITH O-RING



**3722**

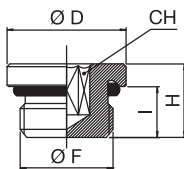

ARTICOLO	F	I	H	D	CH
37220300	M5	4,5	7,2	8	2,5
37220800	1/8	6,5	9,5	14	5
37221700	1/4	8	11,5	17	6
37222600	3/8	9	12,5	20	8
37223500	1/2	10	14	26	10

**TAPPO MASCHIO CILINDRICO  
CON BRUGOLA CON OR VITON**  
ALLEN KEY PLUG WITH O-RING VITON



**3722V**

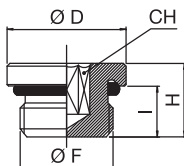

ARTICOLO	F	I	H	D	CH
37220300V	M5	4,5	7,2	8	2,5
37220800V	1/8	6,5	9,5	14	5
37221700V	1/4	8	11,5	17	6
37222600V	3/8	9	12,5	20	8
37223500V	1/2	10	14	26	10

# RACCORDI STANDARD - ACCESSORI - SILENZIATORI

STANDARD FITTINGS - ACCESSORIES - SILENCERS

**TAPPO MASCHIO CONICO  
(A SCOMPARRA)**  
SOCKET HEAD PLUG CONICAL

**3723**

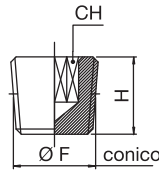

ARTICOLO	F	H	CH
37230800	1/8	7,5	5
37231700	1/4	10	6
37232600	3/8	11	8
37233500	1/2	13	10
37234900	3/4	15,5	14
37235300	1"	17,5	17

**TAPPO MASCHIO  
CILINDRICO (A SCOMPARRA)**  
SOCKET HEAD PLUG CYLINDRICAL

**3724**

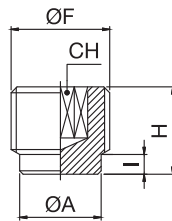

ARTICOLO	F	A	I	H	CH
37240800	1/8	7,5	2	8	5
37241700	1/4	10	3	10	6
37242600	3/8	13	3,5	12	8
37243500	1/2	16	4	14	10

**TAPPO FEMMINA**  
PLUG FEMALE

**3726**

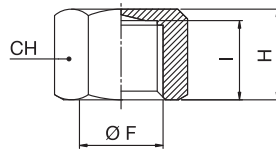

ARTICOLO	F	I	H	CH
37260800	1/8	8	10	14
37261700	1/4	11	13,5	17
37262600	3/8	11,5	14	20
37263500	1/2	14	16,5	24
37264900	3/4	16	18,5	30
37265300	1"	16,5	20	38

**SILENZIATORE NYLON  
DINAMICO**  
NYLON DYNAMIC SILENCER

**3728**

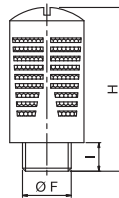

ARTICOLO	F	I	H
37280800	1/8	6	32,5
37281700	1/4	8	43
37282600	3/8	11	58
37283500	1/2	11	58
37284900	3/4	18	115
37285300	1"	18	115

**SILENZIATORE BRONZO  
SINTERIZZATO**  
BRONZE SINTERED SILENCER

**3729**

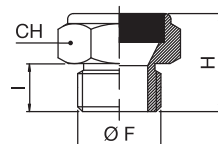

ARTICOLO	F	I	H	CH
37290300	M5	3,5	8	8
37290800	1/8	6	13	13
37291700	1/4	8	16	16
37292600	3/8	9	18	19
37293500	1/2	10	18	24

# RACCORDI STANDARD - ACCESSORI - SILENZIATORI

STANDARD FITTINGS - ACCESSORIES - SILENCERS

**SILENZIATORE RETE**  
NET SILENCER

**3730**

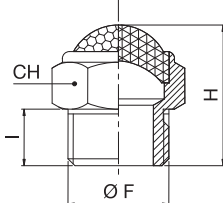
ARTICOLO	F	I	H	CH
37300800	1/8	6	15	13
37301700	1/4	8	18	16
37302600	3/8	8	20	19
37303500	1/2	10	22	24

**SILENZIATORE NYLON STATICO - FELTRO**  
NYLON STATIC SILENCER

**3731**

ARTICOLO	F	I	H	CH
37310800	1/8	6	33	10
37311700	1/4	8	43	12
37312600	3/8	11	58	16
37313500	1/2	11	58	16
37314900	3/4	18	118	25
37315300	1"	18	118	25

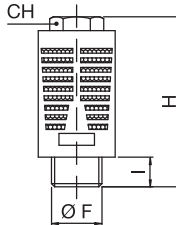
**SILENZIATORE BRONZO**  
BRONZE SILENCER

**3732**

ARTICOLO	F	I	H	CH
37320800	1/8	4,5	21,5	8
37321700	1/4	6	28	10
37322600	3/8	7	36	13
37323500	1/2	8	43	15
37324900	3/4	9	56	19
37325300	1"	11	69	24

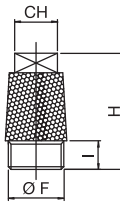
**SILENZIATORE BRONZO**  
BRONZE SILENCER

**3733**

ARTICOLO	F	I	H	CH
37330300	M5	3,5	17	7
37330800	1/8	4,5	21	12
37331700	1/4	6	27	15
37332600	3/8	7	35	19
37333500	1/2	8	40,5	23
37334900	3/4	9	51,5	30
37335300	1"	11	66	36

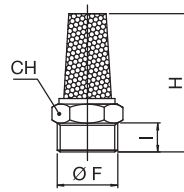
**SILENZIATORE RETE IN NYLON**  
NYLON SILENCER

**3734**

ARTICOLO	F	I	H	CH
37340800	1/8	6	15	13
37341700	1/4	7	18	16
37342600	3/8	8	20	19
37343500	1/2	10	22	24

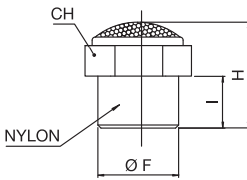
# RACCORDI STANDARD - ACCESSORI - SILENZIATORI

STANDARD FITTINGS - ACCESSORIES - SILENCERS

**PORTAGOMMA FEMMINA**  
HOSE CONNECTOR FEMALE

**3735**

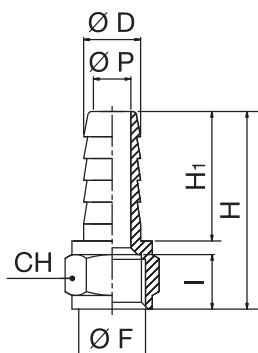

ARTICOLO	D	F	P	I	H	H1	CH
37351570	6	1/8	3,5	8	28,5	19	12
37351580	6	1/4	3,5	11	31,5	19	15
37351610	7	1/8	4,5	8	28,5	19	12
37351620	7	1/4	4,5	11	31,5	19	15
37351660	8	1/8	5,5	8	28,5	19	12
37351670	8	1/4	5,5	11	31,5	19	15
37351710	9	1/8	6,5	8	28,5	19	12
37351720	9	1/4	6,5	11	31,5	19	15
37351730	9	3/8	6,5	11,5	32	19	19
37351750	10	1/8	7,5	8	29,5	20	12
37351760	10	1/4	7,5	11	32,5	20	15
37351770	10	3/8	7,5	11,5	33	20	19
37351780	10	1/2	7,5	14	36	20	24
37351810	12	1/4	9,5	11	32,5	20	15
37351820	12	3/8	9,5	11,5	33	20	19
37351830	12	1/2	9,5	14	36	20	24
37351870	14	3/8	11	11,5	35	22	19
37351880	14	1/2	11	14	38	22	24
37351950	16	3/8	13	11,5	35	22	19
37351960	16	1/2	13	14	38	22	24
37352000	17	3/8	13,5	11,5	37	24	19
37352010	17	1/2	13,5	14	40	24	24
37352060	18	1/2	14	14	40	24	24
37352070	18	3/4	14	15	41,5	24	29
37352120	20	3/4	16,5	15	41,5	24	29
37352140	25	3/4	20,5	15	47,5	30	29

**PORTAGOMMA MASCHIO CONICO**  
HOSE CONNECTOR MALE CONICAL

**3736**

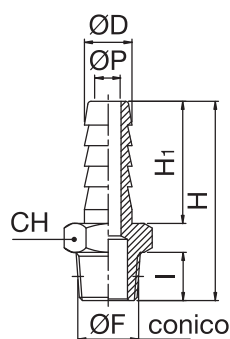

ARTICOLO	D	F	P	I	H	H1	CH
37361570	6	1/8	3,5	8	31,5	19	12
37361580	6	1/4	3,5	11	35	19	14
37361610	7	1/8	4,5	8	31,5	19	12
37361620	7	1/4	4,5	11	35	19	14
37361660	8	1/8	5,5	8	31,5	19	12
37361670	8	1/4	5,5	11	35	19	14
37361710	9	1/8	6	8	31,5	19	12
37361720	9	1/4	6,5	11	35	19	14
37361730	9	3/8	6,5	11,5	35,5	19	17
37361740	9	1/2	6,5	14	38,5	19	22
37361750	10	1/8	7,5	8	32,5	20	12
37361760	10	1/4	7,5	11	36	20	14
37361770	10	3/8	7,5	11,5	36,5	20	17
37361780	10	1/2	7,5	14	39,5	20	22
37361810	12	1/4	9,5	11	36	20	14
37361820	12	3/8	9,5	11,5	36,5	20	17
37361830	12	1/2	9,5	14	39,5	20	22
37361870	14	3/8	11	11,5	38,5	22	17
37361880	14	1/2	11	14	41,5	22	22
37361950	16	3/8	13	11,5	38,5	22	17
37361960	16	1/2	13	14	41,5	22	22
37361970	16	3/4	13	16,5	45	22	27
37362000	17	3/8	13,5	11,5	40,5	24	18
37362010	17	1/2	13,5	14	43,5	24	22
37362050	18	3/8	14	11,5	40,5	24	19
37362060	18	1/2	14	14	43,5	24	22
37362070	18	3/4	14	16,5	47	24	27
37362100	20	3/8	16,5	11,5	41	24	22
37362110	20	1/2	16,5	14	43,5	24	22
37362120	20	3/4	16,5	16,5	46,5	24	27
37362140	25	3/4	20,5	16,5	53	30	27
37362160	25	1"	20,5	19	56	30	34

**RACCORDI STANDARD - ACCESSORI - SILENZIATORI**

STANDARD FITTINGS - ACCESSORIES - SILENCERS

**PORTAGOMMA MASCHIO  
CILINDRICO CON OR**

HOSE CONNECTOR MALE CYLINDRICAL  
WITH O-RING



**3738**

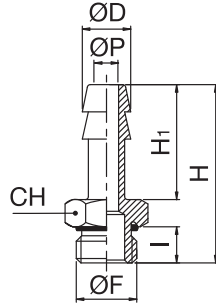

ARTICOLO	D	F	P	I	H	H1	CH
37381070	4,5	M5	2,2	4,5	23	15	8
37381570	6	1/8	3	6,5	30	19	14
37381580	6	1/4	3	8	32	19	17
37381590	6	3/8	3	9	33	19	20
37381610	7	1/8	4	6,5	30	19	14
37381620	7	1/4	4	8	32	19	17
37381660	8	1/8	5	6,5	30	19	14
37381670	8	1/4	5	8	32	19	17
37381680	8	3/8	5	9	33	19	20
37381710	9	1/8	5,5	6,5	30	19	14
37381720	9	1/4	6	8	32	19	17
37381730	9	3/8	6	9	33	19	20
37381750	10	1/8	5,5	6,5	30	19	14
37381760	10	1/4	6,5	8	32	19	17
37381810	12	1/4	8,5	8	33	20	17
37381820	12	3/8	9	9	34	20	20
37381830	12	1/2	9	10	35,5	20	24
37382000	17	3/8	13	9	38	24	20
37382010	17	1/2	13	10	39,5	24	24

**PORTAGOMMA MASCHIO  
CILINDRICO CON OR VITON**

HOSE CONNECTOR MALE CYLINDRICAL  
WITH O-RING VITON



**3738V**

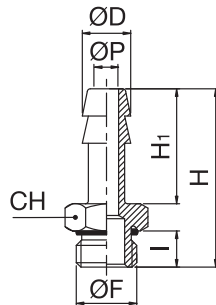

ARTICOLO	D	F	P	I	H	H1	CH
37381070V	4,5	M5	2,2	4,5	23	15	8
37381570V	6	1/8	3	6,5	30	19	14
37381580V	6	1/4	3	8	32	19	17
37381590V	6	3/8	3	9	33	19	20
37381610V	7	1/8	4	6,5	30	19	14
37381620V	7	1/4	4	8	32	19	17
37381660V	8	1/8	5	6,5	30	19	14
37381670V	8	1/4	5	8	32	19	17
37381680V	8	3/8	5	9	33	19	20
37381710V	9	1/8	5,5	6,5	30	19	14
37381720V	9	1/4	6	8	32	19	17
37381730V	9	3/8	6	9	33	19	20
37381750V	10	1/8	5,5	6,5	30	19	14
37381760V	10	1/4	6,5	8	32	19	17
37381810V	12	1/4	8,5	8	33	20	17
37381820V	12	3/8	9	9	34	20	20
37381830V	12	1/2	9	10	35,5	20	24
37382000V	17	3/8	13	9	38	24	20
37382010V	17	1/2	13	10	39,5	24	24



# RACCORDI STANDARD - ACCESSORI - SILENZIATORI

STANDARD FITTINGS - ACCESSORIES - SILENCERS

**PORTAGOMMA MASCHIO  
CILINDRICO**  
HOSE CONNECTOR MALE CYLINDRICAL

**3740**

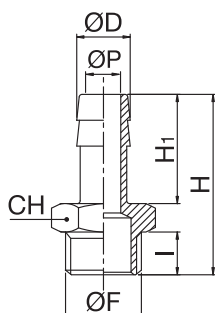

ARTICOLO	D	F	P	I	H	H1	CH
37401070	4,5	M5	2,2	4	22,5	15	8
37401570	6	1/8	3	6	29,5	19	12
37401580	6	1/4	3	8	32	19	14
37401610	7	1/8	4	6	29,5	19	12
37401620	7	1/4	4	8	32	19	14
37401660	8	1/8	5	6	29,5	19	12
37401670	8	1/4	5	8	32	19	14
37401680	8	3/8	5	9	33	19	19
37401710	9	1/8	6	6	29,5	19	12
37401720	9	1/4	6	8	32	19	14
37401730	9	3/8	6	9	33	19	19
37401750	10	1/8	7	6	30,5	20	12
37401760	10	1/4	7	8	33	20	14
37401770	10	3/8	7	9	34	20	19
37401810	12	1/4	9	8	33	20	14
37401820	12	3/8	9	9	34	20	19
37401830	12	1/2	9	10	35,5	20	22
37401870	14	3/8	10,5	9	36	22	19
37401880	14	1/2	10,5	10	37,5	22	22
37402000	17	3/8	13	9	38	24	19
37402010	17	1/2	13	10	39,5	24	22
37402070	18	3/4	15,5	11	41,5	24	30
37402110	20	1/2	14	10	39,5	24	22
37402120	20	3/4	16	11	41,5	24	30

**REGOLATORE DI FLUSSO  
A SPILLO**  
SPIKED FLOW REGULATOR

**3741**

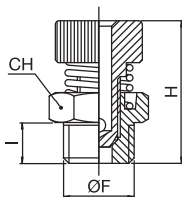

ARTICOLO	F	I	H MIN	H MAX	CH
37410800	1/8	6	23	26	13

**REGOLATORE DI FLUSSO  
SILENZIATO**  
SILENT FLOW REGULATOR

**3742**

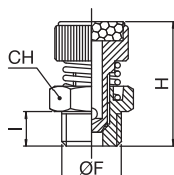

ARTICOLO	F	I	H MIN	H MAX	CH
37420800	1/8	6	26	28	13
37421700	1/4	8	30	32	15
37422600	3/8	9	35	38	18
37423500	1/2	10	36	39	22